

Ground Floor Plan (Production Pt II) as approved
scale 1:100

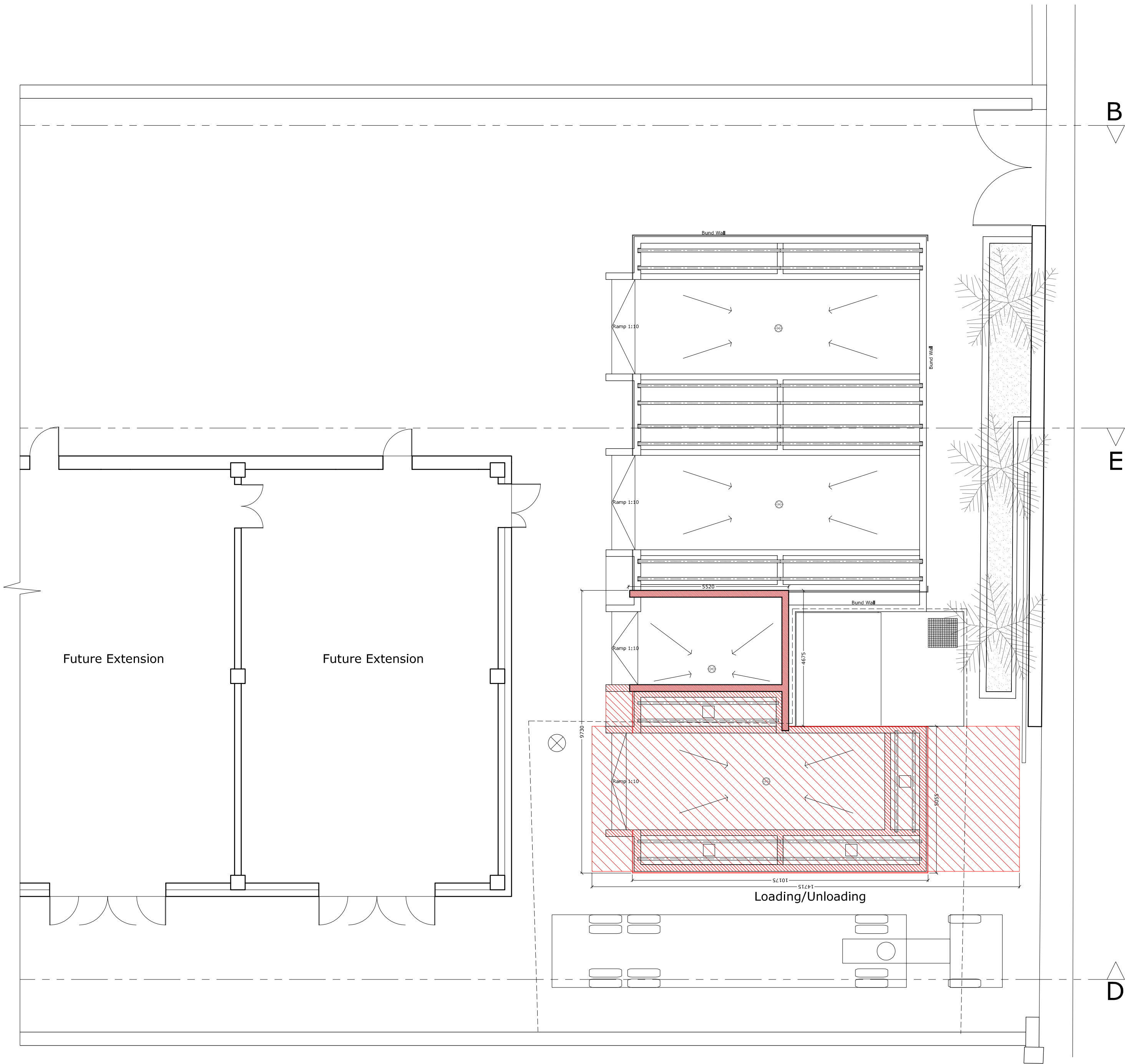

Ground Floor Plan (Production Pt II) as proposed
scale 1:100

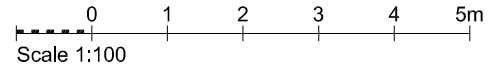

-	-	-	-	-	-
-	-	-	-	-	-
Rev.	Description				Date
<div><div></div><div>Wallace Farrugia & Associates Architects, Civil Engineers & Structural Consultants. No 44, Appt 3, St.Francis Street, Sliema SLM2069 tel:21316758 fax: 21316760</div></div>					
Commission: Extension to External Flammable Warehouse at Sterling Factory					
Client: Sterling Chemicals Ltd					
Drawing Title: Ground Floor Plan as approved by PA 4236/08 (Minor Amendment) & as Proposed(Production Pt II)					
Scale: 1:100			Drawing No: 170-14-032		
Job Ref: 170/14					
Drawn: t.d.	Amended: ..	Approved: ..	Checked: W.F.	Date: 04-03-2015	
Copyright © 2012 WALLACE FARRUGIA & ASSOCIATES					