

## Environmental Permit

Environment Protection Act (CAP. 549)

Permit number

**EP 00224/25**

Approved Documents:

**EP 00224/25/DOC24A**

**EP 00224/25/DOC53A**

**EP 00224/25/DOC54A**

The Environment and Resources Authority (hereinafter the Authority; the Competent Authority or ERA) in exercise of its powers under the Environment Protection Act (CAP. 549) hereby authorises:

**ELA Limited** (hereinafter “the Permit Holder”),  
Company registration number: **C 25736**

Of / Whose Registered Office (or principal place of business) is at:

**31, Wied Ghammieq Road.**  
**Kalkara**

To carry out waste management operations as per conditions and limitations stipulated in this authorisation at:

**31, Wied Ghammieq Road.**  
**Kalkara**

This permit is valid for **four (4) years** from the granted date below.

Signed

Date

 <p>Perit Vincent Cassar Chairperson</p>	Permit Granted: <b>12.12.25</b>
---	---------------------------------

**Authorised to sign on behalf of the Competent Authority**

**This page has deliberately been left blank**

## Conditions

### 1 General

The Permitted Installation shall, subject to the conditions of this Permit, be managed, controlled and operated as described in the Application, or as otherwise previously agreed in writing by the Authority.

#### 1.1 Permitted Operations

1.1.1 The Permit Holder is authorised to carry out the operations and the associated operations specified in Table 1.1.1.

**Table 1.1.1**

Operation	Description of specified operation	Limits of specified operation
Category 1.10 of SL 549.172:  Non-hazardous waste collection, treatment, disposal, temporary storage and, or preparation for reuse (including packaging, sorting and, or processing of waste prior to reuse or recovery), except waste generated on the same site.	<i>Acceptance, temporary storage and processing of non-hazardous waste as per Schedule 1:</i>  Receipt, storage and processing of non-hazardous scrap metal and wire stripping in designated areas.  Receipt, storage and processing of depolluted ELVs.	From receipt and processing of waste metals and wire cables to dispatch to authorised waste facilities locally or abroad.  From receipt and processing of depolluted ELVs to dispatch to authorised waste facilities locally or abroad.
Category 1.12 of SL 549.172:  Hazardous waste collection, temporary storage, treatment, (including packaging sorting and, or processing of waste prior to preparation for reuse, recycling or recovery), preparation for reuse, recycling and, or disposal except waste generated on the same site.	<i>Acceptance, temporary storage and processing of hazardous waste as per Schedule 1:</i>  Receipt, storage and processing of ELVs as per S.L. 549.36, as well as vehicles other than those covered in S.L. 549.36, and related sorting and storage of separated components as per approved document <b>EP 00224/25/24A</b> in areas as per Condition 1.2.1.	From receipt of ELVs (limited to ICE vehicles only) to dispatch of separated components to authorised waste facilities either locally or abroad.  The sale of material arising from the ELV process as second-hand parts as per section 3.6.

---

*Associated operations:*

<p>Extraction of refrigerant gases and waste compressor oil from ELV's air conditioning units as per approved document <b>EP 00224/25/24A</b> including the separation of the resultant gases and oils into separate fractions for disposal, resale or reuse.</p>	<p>From extraction of gases and storage in specified refillable containers to either disposal at a Commission approved destruction facility (HCFCs) or for resale/reuse as recovered refrigerant (HFCs only).</p> <p>From extraction to storage and dispatch of extracted compressor oil to authorised facilities either locally or abroad.</p>
<p>Operation of shear/baler for the processing of waste metals.</p>	<p>From receipt and processing to dispatch of processed metals to an authorised waste facility either locally or abroad.</p>
<p>Operation of stand-by generator.</p>	<p>From receipt of fuel to delivery of utility.</p>

---

## 1.2 Site

- 1.2.1 The operations authorised under condition 1.1.1 shall not extend beyond the Site, as shown on the Site Map in Schedule 2 to this Permit.
- 1.2.2 Whenever there is a conflict between the conditions of this Permit and approved documents, the conditions of the Permit shall prevail.
- 1.2.3 The Permit Holder shall complete all infrastructural upgrades in accordance with **EP 00224/25/DOC54A** within the permit validity period. Each phase shall be secured by a bank guarantee of €2,000, amounting to a total of €6,000, as follows:
- i. Recycling Process Infrastructure; (€2,000)
  - ii. ELV Processing Zone; (€2,000)
  - iii. Storage and Dispatch Facilities. (€2,000)

The Permit Holder shall notify the Authority upon completion of each phase to enable verification and release of the corresponding bank guarantee. The release shall follow condition 5.12.

- 1.2.4 Upon completion of all infrastructural works an updated fire plan by an independent third party warranted engineer with a specialisation in fire safety, and/or an affiliation with a Fire Safety Organisation; is to be submitted outlining all fire measures in place once the site is upgraded and any recommendations with timeframes of implementation, is also proposed to be included.

### 1.3 Conditions to be enforced by other Entities

- 1.3.1 The conditions to be imposed and enforced by the Environmental Health Directorate are outlined in approved document **EP 00224/25/DOC53A**.

## 2. Operating Conditions

### 2.1 Emissions to Air

- 2.1.1 All processes which generate significant levels of airborne contaminants (such as dusts, toxic gases, odorous chemicals) shall have effective local collection and shall discharge (after treatment where necessary) through a stack or vent located and/or designed in such a way as to avoid local effect.
- 2.1.2 Emissions to air shall only arise from the emission points specified in Table 2.1.2, as per description in the submitted EP Application.

<b>Emission point references</b>	<b>Source</b>
PS1	Standby-by generator
PS2	Shearer/baler

- 2.1.3 ERA recommends that diesel (gas oil) used for the generator shall have a Sulphur content not greater than 0.1%.
- 2.1.4 The co-incineration of any material or additional fuel including engine or other waste oil is strictly prohibited. Any change in fuel type shall require the notification and approval of the Authority prior to commencement of its utilisation.
- 2.1.5 Should the Permit Holder intend to install equipment, which could lead to additional emissions to air (e.g. boiler, etc.), a variation of this Permit must be secured prior to installation and operation of this equipment.
- 2.1.6 The Authority may request monitoring of emissions to air listed in table 2.1.2 which shall be undertaken in accordance to the terms of reference provided by the Authority.
- 2.1.7 The Permit Holder shall submit certification for the generator (PS1) referred to in table 2.1.2, by an independent warranted engineer showing that the generator is in good working condition with the renewal application.
- 2.1.8 All abatement equipment and ducting shall be cleaned and maintained on a regular basis (as per manufacturer specifications). Record of such maintenance shall be kept and may be requested for inspection by the Authority.
- 2.1.9 The Permit Holder shall prevent or where that is not practical, reduce fugitive emissions of substance to air from the Permitted Installation.
- 2.1.10 In the event of malfunction leading to abnormal emissions, the Permit Holder must:
- a. Investigate immediately and undertake the corrective actions;
  - b. Adjust the process/operation to minimise those emissions;

- c. Record the cause of malfunction and actions taken;
- d. In the event of non-compliance causing immediate danger to the environment, operation of the operation must be suspended and the Competent Authority informed within 24 hours.

2.1.11 Further to condition 2.1.10, the Permit Holder shall provide ERA with details of the specific cause of the malfunction and the remedial steps taken or to be taken to address the malfunction.

2.1.12 If the Authority deem it necessary, the Permit Holder may be required to apply suitable abatement measures to any equipment related to the physical alteration of the scrap metal (e.g. shearers, balers) to prevent escape of particulates created by the processes related to this equipment.

## **2.2 Effluent Discharges and emissions to land**

2.2.1 No discharges and/or emissions of pollutants to surface water, groundwater and/or land shall take place from the Permitted Installation.

2.2.2 Foul sewer drains must be strictly segregated from storm water drains.

2.2.3 The Permit Holder shall undertake all necessary measures and precautions to prevent spillage of raw materials, intermediates, products, waste and any other materials.

2.2.4 The Permit Holder shall ensure that all eventual cesspits are maintained as per SL 549.45, the Waste Management (Activity Registration) Regulations. Therefore, cesspits are to be constructed in such a manner as not to allow leakages or spillages of waste effluent into the surrounding environment. In addition, cesspits shall be appropriately ventilated so as to avoid the accumulation of explosive, toxic or corrosive gases. The area surrounding the cesspit shall be rendered impermeable and the ground laid to fall towards the cesspit.

2.2.5 All cesspits within the installation shall be maintained and certified once in place as per specifications listed in condition 2.2.4 by a competent professional by a competent professional and submitted to the Authority with the application for renewal. Records of regular maintenance and emptying of cesspits shall be kept for a minimum period of 5 years and be made available, upon request, to the authority.

2.2.6 The eventual designated oil interceptor shall be monitored and maintained to ensure efficient operations. A log of monitoring and waste removal from the interceptor once in place shall be maintained on site and be available for inspection by the Authority. Such waste removal shall also be included in the Annual Environmental Report.

2.2.7 The oil interceptor is also to be inspected and certified by an independent warranted architect or engineer as per EN 858 at least once every year and submitted as part of Schedule 3 once installed. The warranted architect or engineer shall amongst other things inspect the interceptor for efficiency of operation. Certification produced by the architect or engineer shall be included in the Annual Environmental Reports.

- 2.2.8 Process effluent shall not be diluted prior off-site transfer to authorised facilities.

### **3 Site Infrastructure and Operations**

#### **3.1 Site Infrastructure**

- 3.1.1 During non-operating hours, the site shall be locked and totally inaccessible to third parties, both by vehicle and on foot. The site must be well secured at all times.
- 3.1.2 The designated and labelled quarantine area shall be kept within the site boundary to temporarily hold unpermitted waste that may inadvertently enter the site. A non-leaking skip or similar contained structure shall be utilised for the temporary storage of unpermitted waste. The quantity of waste in the quarantine area shall not exceed the capacity of said area at any given time.
- 3.1.3 No non-depolluted ELVs shall be deposited, stored, treated or otherwise handled in any area of the site that is not impermeable and where thorough clean up and site reinstatement cannot be readily undertaken, until the engineered site containment and drainage system for that area has been constructed and completed. Such waste shall only be stored in the areas indicated in figure 2.2 in Schedule 2 for such uses.
- 3.1.4 The Permit Holder is to ensure that the waste is organised into the designated areas, labelled and visible physical delineation of these areas in place.
- 3.1.5 Following completion of works carried out, the engineered site containment and drainage systems shall be inspected, to be fit for purpose and in line with the following construction quality assurance standards. All areas are to be:
- a. fully impermeable;
  - b. be immediately repaired in case of any damage which could increase permeability;
  - c. are to be certified as being resistant to physical, mechanical and chemical stresses to which they may be subjected; and
  - d. fall towards an oil/water interceptor prior to passing through the drainage system to prevent pond formation.
- 3.1.6 Certification for site containment and drainage systems as per condition 3.1.5 shall be submitted to ERA for all the areas upon completion of works and with the submission of a renewal application.
- 3.1.7 No waste shall be deposited, stored, treated or otherwise handled in any area of the site that is not impermeable. No liquid wastes are allowed to be kept on site with the exception of those generated from the processes on site.
- 3.1.8 The Permit Holder shall also ensure and take all precautions in his competence to avoid any leakages or spills from liquid materials that can caused environmental harm. Waste liquid tanks and drums found to be leaking or damaged shall either be immediately transferred to a larger over-container or shall have their contents immediately transferred to an alternative tank.
- 3.1.9 Any bulk oil, waste oils/fuels, and fuel storage tanks shall be provided with an adequately designed bund system with an impermeable base and walls, as per

relevant standards. The capacity of the bund shall be a minimum of 110% of the largest tank within the bund or 25% of the total volume of all the tanks within the bund, whichever is greater. Filling and off-take points shall be located within the bund. The Permit Holder shall also ensure and take all precautions to avoid any leakages or spills from liquid or solid material. Certification is to be provided by an independent and warranted engineer and submitted to the Authority with the next renewal application.

3.1.10 All waste oils and fuel storage bunds shall be certified for integrity, certification for which is to be submitted upon application for renewal.

3.1.11 If the Permit Holder makes use of a flexible pipe to deliver the fuel, the Permit Holder shall ensure that the following conditions are observed:

- The delivery end of the pipe is fitted with a pump or valve that closes automatically when not in use.
- The valve or pump must be lockable and must be kept so when not in use.
- The end of the pipe that leaves the tanker must be fitted with a lockable valve that must be shut when it is not in use.

### **3.2 Permitted Operations on Site**

3.2.1 Only waste streams as set out in the European Waste Catalogue (EWC) codes in Schedule 1 can be accepted and processed on site. Processing is to be carried out according to the approved document **EP 00224/25/24A**.

3.2.2 The total quantity of non-depolluted ELVs, waste batteries, waste oils, and any other hazardous wastes, stored at one point in time at the permitted facility shall not exceed 49 tonnes when combined. Processing (i.e. depollution and dismantling) of ELVs shall not exceed 10 vehicles per day. The operations on site are to strictly abide by the site layout plan in the permitted site layout plan as per Schedule 2.

3.2.3 Waste tyres shall be segregated from other wastes and applicable and adequate firefighting equipment shall be kept within close proximity to this waste stream. Temporary storage of tyres may only take place within the area designated for this operation. No waste tyres can be accepted as a specific waste stream on site. The maximum amount of waste tyres kept on site originating from ELV processing at the facility, shall not exceed 10,000 tonnes at any one time.

3.2.4 Storage of waste batteries is to be carried out indoors (not open to the elements) or in closed leak-proof containers that has impermeable ground in order to facilitate the clean-up of potential spills.

3.2.5 The crushing of waste gas cylinders is not permitted on site unless a method statement of how this is to be carried out is submitted is approved by the Competent Authority.

### **3.3 Equipment on Site**

- 3.3.1 The weighing equipment shall be maintained, calibrated, and certified by an independent warranted engineer or by the equipment's manufacturing company. This certificate is to be submitted to the Authority as part of the Annual Environmental Report (AER) in Schedule 3.
- 3.3.2 All plant, equipment and technical means used and yet to be installed for operating the Permitted Installation shall be maintained in good operating condition and without causing polluting emissions, leaks and spillages. Maintenance records of the above shall be kept by the Permit Holder, and must be made available to the Authority upon request.

### **3.4 General Waste Acceptance, Storage, and Handling**

- 3.4.1 The Permit Holder shall apply the precautionary principle to safeguard the environment whilst carrying out the permitted operation and shall immediately refuse the entry of waste that is suspected to be in breach of the conditions of this permit.
- 3.4.2 The Permit Holder shall ensure that the waste management operations authorised in accordance with this Permit are carried out in an orderly manner and in such a way as not to cause adverse impact on the environment.
- 3.4.3 All wastes leaving the site after storage and/or processing must only be sent to facilities licensed to accept the individual waste stream, either locally or abroad. In this regard, in the case of local facilities, the Permit Holder shall only make use of disposal/recovery sites that are duly permitted by the Competent Authority, as set in the Subsidiary Legislation 549.63 – the Waste Regulations or by authorised waste management facilities abroad.
- 3.4.4 All wastes shall be stored within a designated and controlled storage area(s) prior to removal from site to an authorised facility either locally or abroad. Any unpermitted wastes that may inadvertently enter the site must be stored in the quarantine area prior to removal from site.
- 3.4.5 No waste (including end-of-life vehicles awaiting depollution) shall be handled beyond the boundary of the permitted site area as indicated in Schedule 2.
- 3.4.6 Movements of waste outside of the permitted facility for the purpose of loading may not commence prior to the arrival of the truck/container on site.
- 3.4.7 The Permit Holder is to prevent litter or other wastes escaping from the site boundaries particularly during loading/unloading. Any such escape of waste shall be collected immediately upon detection.
- 3.4.8 The Permit Holder shall make use of the services of a registered waste carrier for the transport of waste from the site in accordance with activity 38 of Schedule 1 of Subsidiary Legislation 549.45, the Waste Management (Activity Registration) Regulations. Where the company removes wastes using its own transport, the vehicle(s) must also be registered as a waste carrier in accordance with S.L. 549.45 or any statutory provisions or regulations amending or replacing them.

3.4.9 Should the Permit Holder require the services of a waste broker, it shall be ensured that any such broker is a duly registered waste broker in accordance with S.L. 549.45.

3.4.10 Transboundary movement of waste shall be carried out in accordance with the following regulations, as amended from time to time:

- a. Regulation (EC) N° 1013/2006 of the European Parliament and of the Council of 14 June 2006 on shipments of waste as implemented through S.L. 549.65;
- b. Regulation (EU) 2024/1157 of the European Parliament and of the Council of 11 April 2024 on shipments of waste, amending Regulations (EU) No 1257/2013 and (EU) 2020/1056 and repealing Regulation (EC) No 1013/2006;
- c. Any other applicable legislation.

3.4.11 The Permit Holder shall ensure to provide:

- i) A receipt at the point of acceptance indicating the facility name, permit number, date, time and weight of the consignment, and should also bear a unique sequential number.
- ii) A declaration for all the consignments of waste accepted and removed on Site shall also be issued indicating the facility name, permit number, type, weight and final destination of the waste removed, also bearing a unique sequential number.
- iii) In case of packaging waste as per obligations of S.L. 549.43 the declaration shall also be accompanied with recovery/disposal certificates provided by the Authority, examples of which are annexed as Schedule 7 of this Permit, copies of which are to be provided to the person/company handing over the waste to be recycled on a quarterly basis (i.e. one certificate covering January, March, April to June, July to September, October to December respectively). Digital copies of which shall be submitted on an annual basis as part of the AER. Hard copies of the Recovery/Disposal Certificates are also to be sent to the Authority every quarter accordingly.

In cases of non-waste carriers or domestic sources, a receipt would suffice.

3.4.12 Disposal and/or recovery certificates and any documentation related to transfer of waste to and from the site and/or related to its end disposal and/or recovery shall be kept on record and made available for inspection for a period of at least 5 years from date of their issue. Copies of such certificates shall be submitted on an annual basis as part of the AER.

3.4.13 The Permit Holder shall maintain records of the weight of each waste consignment received and/or removed from the site, and such data shall be collected using properly calibrated equipment.

- 3.4.14 All hazardous waste transferred to and from the site and every individual movement of hazardous waste shall be accompanied by a valid consignment permit and consignment note obtainable from the Competent Authority.
- 3.4.15 An audit trail is to be maintained for the waste received and sent for treatment, recovery or disposal to another facility locally or abroad, which audit trail shall cover all waste from the point of generation or collection to the end recovery facility abroad.
- 3.4.16 No storage of waste destined for disposal is permitted for a period exceeding 12 months. No storage of waste destined for recovery or treatment is permitted for a period exceeding 3 years.
- 3.4.17 No liquid wastes shall be accepted on site except those arriving as part of end-of-life vehicles. Minor spillages of liquid waste shall be cleaned up immediately.

### **3.5 ELV waste and treatment**

- 3.5.1 Storage and processing of ELVs shall follow the methodologies described in the approved document **EP 00224/25/DOC24A**. Any change in this method statement shall be subject to approval by the Authority.
- 3.5.2 The Permit Holder shall comply with the minimum technical requirements as stipulated by Regulation 6 and Schedule 2 of the Subsidiary Legislation 549.36 - the Waste Management (End of Life Vehicles) Regulations.
- 3.5.3 All wastes arising from dismantling and depollution of ELVs must be segregated in designated storage areas for each waste stream. These storage areas must be clearly labelled and no mixing of different hazardous wastes is permitted.
- 3.5.4 Motor vehicles other than M1 and N1 vehicles as defined in Part A of Schedule II to the EC Type-Approval of Motor Vehicles and their Trailers Regulations, and three-wheel motor vehicles as defined in the Approval and Market Surveillance of Two or Three-Wheel Vehicles and Quadricycles Regulations must be treated separately from M1 and N1 and three-wheel motor vehicles.
- 3.5.5 Further to condition 3.5.4, vehicles other than M1 and N1 vehicles as defined in Part A of Schedule II to the EC Type-Approval of Motor Vehicles and their Trailers Regulations, and three-wheel motor vehicles as defined in the Approval and Market Surveillance of Two or Three-Wheel Vehicles and Quadricycles Regulations shall be reported separately, particularly in view of reporting requirements as established in Schedule 3 of this permit.
- 3.5.6 All vehicle de-pollution and dismantling of any oil contaminated parts are to be carried out indoors or under a covered designated area. Any runoff from these areas shall be directed to pass through an appropriate oil/water interceptor.
- 3.5.7 The Permit Holder shall issue a certificate of destruction once the End-of-Life vehicle is transferred to the facility. The certificate shall contain at least the minimum requirements for the certificate of destruction as set out in Schedule 4 of this permit.

- 3.5.8 The certificate of destruction is to be issued to the last holder and/or owner of the vehicle. A copy of the certificate is to be retained by the Permit Holder for his own records, for a minimum period of five years following issue of said certificate. The Authority shall be provided with copies of such certificates upon request.
- 3.5.9 End-of-life vehicles shall be stripped in line with the requirements of Schedule II of S.L. 549.36 before further treatment or other equivalent arrangements are made in order to reduce any adverse impact on the environment. Such stripping operations and storage shall be carried out in such a way as to ensure the suitability of vehicle components for reuse, recovery and recycling.
- 3.5.10 The Permit Holder shall ensure that a reuse and recovery rate of 95% by an average weight per vehicle and year is achieved, and that a reuse and recycling rate of 85% by an average weight per vehicle and year is achieved.
- 3.5.11 Care shall be taken to ensure hazardous materials and components from dismantled ELVs are handled and stored in a way so as not to contaminate other waste.
- 3.5.12 Containers for storage of refrigerants and residual materials shall be inspected daily for leaks. Containers found to be leaking either shall be immediately transferred to a larger over-container or shall have their contents immediately transferred to an alternative container.
- 3.5.13 Containers used for refrigerant gas intended for resale must be refillable and in line with Directive 2010/35/EU on transportable pressure equipment.
- 3.5.14 All degassing of ELVs and their components from processing of air conditioning units from vehicles shall be undertaken on an impermeable and bunded surface.
- 3.5.15 Only HFCs may be collected for resale. All HCFCs collected from the degassing of ELVs and from oil filtering equipment must be exported as waste to a Commission approved destruction facility. Such facilities must be in line with destruction technologies listed in Annex 7 of EC Regulation No 1005/2009.
- 3.5.16 Each tank, drum or other mobile container used to hold wastes associated with the operation of the plant (particularly refrigerant gases) shall be clearly and unambiguously labelled regarding its contents.
- 3.5.17 Drums and containers of waste compressor oils and gases shall be stored in designated and secure storage areas (in closed containers to avoid release of ODS). Any recovered refrigerant gas shall not be stored in disposable containers. Storage areas shall be bunded or otherwise designed so that surface and ground waters cannot be contaminated by spillages. Should drip trays be used in lieu of a fixed bunded structure, the drip trays must be able to hold at least 25% of the total storage capacity of the drums.
- 3.5.18 De-Gassing of ELVs shall be undertaken in a manner to ensure fugitive emissions from the degassing of the refrigeration cooling system are collected.
- 3.5.19 All operations involving the extraction of Ozone Depleting Substances from vehicle air conditioning systems need to abide by the requirements of EC Regulation

1005/2009 on substances that deplete the Ozone Layer & SL 549.58 on substances that deplete the ozone Layer, Regulations 2007.

- 3.5.20 All foams containing substances falling within the scope of EC Regulation 1005/2009 on substances that deplete the Ozone Layer & SL 549.58 on substances that deplete the Ozone Layer extracted from the ELVs shall be processed as per the requirements of these Regulations and Subsidiary Legislation.
- 3.5.21 In the case of refrigerated vehicles (including refrigerated containers), the Permit Holder shall submit a Method Statement describing how the dismantling of such vehicles is proposed to be carried out, taking into account all Ozone Depleting Substances (ODS) contaminated materials (e.g. insulating foams, compressor oils, etc.). The Method Statement shall indicate:
- a. Whether (a) the panels will be crushed and ODS extracted in a closed system; or (b) sent as panels to a European Commission approved destruction facility.
  - b. How ODS in the refrigerating unit used to cool the refrigerated compartment shall be extracted.
  - c. How the following requirements will be met:  
Compressor oil from the cooling system shall be placed immediately in a suitable sealed container to prevent fugitive loss of controlled substances. Following the drainage of the cooling system the compressor unit shall be removed from the refrigerator unit and placed into a sealed container. This processing shall be undertaken in a manner to ensure fugitive emissions from the degassing of the refrigeration cooling system are collected.

No dismantling of such vehicles may take place prior to this Method Statement being approved by the Authority.

- 3.5.22 In the event of damage or deterioration to a container that is, or is likely to cause a leak, that container shall be repaired or replaced immediately as per condition 3.5.23 below.
- 3.5.23 Removal of waste air conditioning equipment from ELVs shall be undertaken in a manner to prevent release of ODS and fluorinated greenhouse gases.
- 3.5.24 Drainage of the refrigeration cooling system of air-conditioning units shall be undertaken in a manner that results in the removal of 99% of the refrigerant from the cooling circuit being collected and shall be stored in a sealed container.

### **3.6 Second-hand parts recovered as a result of ELV dismantling**

- 3.6.1 The Permit Holder shall provide the appropriate storage for dismantled spare parts, including impermeable storage for oil-contaminated spare parts, which would need to be kept separately from waste parts/material.
- 3.6.2 The Permit Holder shall check, clean and/or repair parts/components to ensure that the parts/components can be reused without any further re-processing prior to

placing on the market. An official declaration is to be issued to consumers by the Permit Holder certifying that the parts/components are fit for reuse especially important for second hand parts intended for export. Such a declaration is to include the following:

- A description of the parts/components,
- The weight and/or number,
- Marque of the end-of-life vehicle from which they were dismantled,

3.6.3 Before dismantling commences, fluids (fuel, motor oil, transmission oil, gearbox oil, hydraulic oil, cooling liquids, anti-freeze, brake fluids, air conditioning system fluids and any other fluid contained in the end-of-life vehicle) that are necessary for the reuse of the certain parts, are to be stored in appropriate containers.

3.6.4 Parts/components removed from vehicles put on the market before 1 July 2003 which contain lead, mercury, cadmium or hexavalent chromium are not to be reused in the repair of vehicles put on the market after 1<sup>st</sup> July 2003 in the case of M1 and N1 vehicles only as per ELV Regulations S.L. 549.36. These parts are to be recycled or recovered in authorised treatment facilities.

3.6.5 Condition 3.6.4 applicable only to M1 and N1 vehicles only as per ELV Regulations S.L. 549.36, shall not apply in the following cases:

- a. spare parts which are to be used for vehicles put on the market before 1 July 2003;
- b. spare parts which are exempt in accordance with schedule 3 as per S.L. 549.36, the Waste Management (End of Life Vehicles) Regulations.

3.6.6 The following parts/components must not be sold for reuse in the construction of new vehicles in accordance with Annex V of Directive 2005/64/EC on the type approval of motor vehicles with regard to their reusability, recyclability and recoverability and amending Council Directive 2007/46/EC:

- a. All airbags, including cushions, pyrotechnic actuators, electronic control units and sensors<sup>1</sup>;
- b. Automatic or non-automatic seat belt assemblies, including webbing, buckles, retractors, pyrotechnic actuators;
- c. Seats (only in cases where safety belt anchorages and/or airbags are incorporated in the seat);
- d. Steering lock assemblies acting on the steering column;
- e. Immobilisers, including transponders and electronic control units;
- f. Emission after-treatment systems (e.g. catalytic converters, particulate filters);

---

<sup>1</sup> When the airbag is inserted inside the steering wheel, the steering wheel itself

g. Exhaust silencers.

3.6.7 All engines being sold as second-hand goods must be accompanied by a certificate from the Permit Holder verifying the engine is in good working condition and has been properly dismantled, drained and bunged at an authorized facility, retaining no more oil than necessary to prevent corrosion during storage and transfer. This is especially important if the engine is destined for export. The certificate is to include the following details:

- marque of the end-of-life vehicle;
- engine size (cc);
- fuel; and
- engine number.

3.6.8 Parts/components destined for export must be subject to the following checks:

- a. The items within the shipment are functional and fit for direct re-use.
- b. Shipments of such items and substances therein are not prohibited according to national legislation and the legislation of the country of destination.
- c. Items are properly packaged to protect from damage during transportation, while also allowing proper visual inspection of all items within the shipment.
- d. The items within the shipment have a market value.

3.6.9 Parts/components destined for export must be accompanied with the following documents:

- a. A certificate or a declaration issued by a suitably qualified, certified or trained technician, declaring that the parts/components are suitable for re-use for their original purpose and meet all relevant European and national legislation and standards;
- b. A detailed packing list of what is found within the shipment, including details on:
  - A description of the parts/components
  - Marque of the ELV from which the part/components were dismantled;
  - Quantities, and
  - Serial numbers, where applicable.
- c. A declaration that the parts/components are not waste as defined by Regulation 4 of SL 549.63, the Waste Regulations;
- d. A copy of the invoice and/or contract relating to the sale of the parts/components;
- e. Relevant transportation documents provided by the Competent Authorities.

#### **4. Site Management**

##### **4.1 Staff obligations and Responsibilities**

- 4.1.1 All employees authorised by the Permit Holder to undertake waste management operations on his/her behalf, shall be fully conversant with the obligations of this permit and shall be individually aware of their responsibilities and liabilities in observing the conditions of this permit.
- 4.1.2 One member of the staff shall be nominated as the Technically Competent Person (TCP) of the site, whereby this person is to physically represent the Permit Holder during the times when the Permit Holder will not be available.
- 4.1.3 Where the Permit Holder is also the designated TCP for the facility, a delegate TCP should also be appointed to represent the Permit Holder/TCP during the times when the Permit Holder/TCP will not be available.
- 4.1.4 The TCP is responsible for the implementation of all the obligations stipulated in this permit, must supervise the rest of the staff on site and is completely responsible to ascertain that all permit conditions are being adhered to.
- 4.1.5 In the event of any short or long periods of leave of absence taken by the TCP, for a period exceeding 10 days, the Permit Holder is obliged to find a replacement for that member of staff without delay and the Authority informed accordingly.
- 4.1.6 All the staff on site shall be fully aware of the procedures to be taken to contain any environmental hazard, which may arise related to the operations being carried out on site.

##### **4.2 Accident Prevention and Control**

- 4.2.1 The Emergency Response Plan (including a fire plan) shall be maintained and adhered to. The ERP shall contain details of the location, nature and quantity of chemicals, oils and fuels stored, any special hazards, a drawing showing location of drains and the emergency phone numbers of the Permit Holder and relevant authorities. It shall also include actions to be taken in the case of incidents which could affect the environment, such as fires and chemical/fuel spills. The emergency plan shall indicate that accidental releases of chemicals and fires caused by chemicals are to be managed as specified in the respective Safety Data Sheets (SDS).
- 4.2.2 In the case of an accident (including fires, chemical spills, etc.), the Permit Holder shall follow the Emergency Response Plan referred to in Condition 4.2.1 and shall notify the Authority within immediately.
- 4.2.3 In the event of accidents, that may lead to contamination of the surrounding environment, the Permit Holder shall notify the Authority within 24 hours and take immediate action as may be directed by the Authority. The Authority reserves the right to request any studies, measures, or actions it deems necessary, including but not limited to investigations, risk assessments, remedial works, and preventive measures to ensure the protection of the environment.

- 4.2.4 Spillages of fuels, chemicals or other hazardous material shall receive immediate attention to prevent escape to drain, surface water or land. Spilled material shall be disposed of in an appropriate manner. Kits for the collection of liquid and powder spills shall be available on site at strategic locations.
- 4.2.5 Small leaks or spills shall be cleared up immediately by the application of absorbent materials. All used absorbent materials shall be disposed of as hazardous waste at facilities permitted to accept such waste. Transfer of this waste shall be carried out as per conditions specified in this permit.
- 4.2.6 The Permit Holder shall have in storage an adequate supply of suitable absorbent material to absorb any spillage.

### **4.3 Site Records**

- 4.3.1 A site daily operations log shall be made in a legible manner and kept on site and be made available for inspection by the Authority at any reasonable time. The following information shall be recorded on a daily basis and retained for five (5) years:
  - a. Total amount of waste in tonnes accepted on site;
  - b. Total amount of waste in tonnes removed from site for disposal or further treatment;
  - c. Total amount of waste in tonnes refused entry on site;
  - d. Total amount in tonnes of unaccepted material sent to the quarantine area and by which registered waste carrier it was transported;
  - e. Any incidents that took place on site such as mechanical faults in the machinery or equipment used on site, any spills, fires, etc. and the remedial action taken;
  - f. Any other incidents that the Permit Holder deems important to record in the Site daily operations log; and
  - g. Any complaints related to the operations at the site.

Each record shall be compiled within 24 hours of the relevant event. The records kept in the site daily operations log shall be made available for inspection at any time when the Authority representative request to inspect them.

- 4.3.2 The Permit Holder shall maintain a record of the skills and training requirements for all staff whose tasks in relation to the Permitted Installation may have an impact on the environment and shall keep records of all relevant training.
- 4.3.3 The Permit Holder may wish to establish an Environmental Management System (EMS) to facilitate compliance with permit conditions and to assist in formalising procedures required by this permit. An EMS can take the form of a standardised system (e.g. EN ISO 14001:1996 or EMAS) or a non-standardised (“customised”) system, provided that is properly designed and implemented. Guidance for a non-standardised (“customised”) system is included in Schedule 5 of this permit.

### **4.4 Reporting and Notifications**

- 4.4.1 The Permit Holder shall submit to the Authority an Annual Environmental Report (AER), together with the Audit mentioned in condition 4.4.3 below of the previous

year by not later than 31<sup>st</sup> March of each year, providing the information listed in the ERA website and in the format specified therein (<https://era.org.mt/era-topic-categories/reporting-obligations/>) and Schedule 3. It shall also be ensured that all certification and documentation as per Schedule 3 are submitted in accordance with their relevant timeframes to the Authority addressed to the Compliance and Enforcement Unit, Environment and Resources Authority.

- 4.4.2 The Permit Holder shall obtain certification/declaration from the exporter showing the achieved Recycling Efficiencies for the waste batteries. In case of direct export, the Permit Holder shall obtain from the recycling facility abroad, the Recycling Efficiency Certificates, showing the recycling efficiencies achieved for all the batteries consignments dispatched from the site. The Recycling Efficiency Certificates (for that specific year) pursuant to Commission Regulation (EU) No 493/2012 shall be submitted to the Authority as part of the AER in line with condition 4.4.1.
- 4.4.3 An independent auditor shall be engaged by the Permit Holder to certify all of the waste reporting required by this permit, in line with the Audit Procedures - Terms of Reference found in Schedule 6 of this permit. The results of such audit are to be submitted to the Authority in the form of a report, as part of the AER or by the 31<sup>st</sup> of March of each reporting year. The Authority may carry out any such audits on the installation itself as deemed necessary at the expense of the Permit Holder in line with condition 5.9.
- 4.4.4 All reports and written and/or verbal notifications required by this Permit shall be made and sent to the Authority addressed to the Compliance and Enforcement Unit, Environment and Resources Authority.
- 4.4.5 The Permit Holder shall provide a reply to any clarifications which the Authority may have about any documentation or submissions made within the timeframe stipulated by the Authority.
- 4.4.6 In the event where operations cease temporarily, the TCP or Permit Holder are obliged to notify the Authority within two (2) days and are also to inform the Authority with regards to when the works are intended to resume.

#### **4.5 Operational Changes**

- 4.5.1 The Permit Holder may apply for a modification in permit and shall seek the Authority's written agreement prior to any operational changes, by sending to the Authority:
  - a) Written notice of the details of the proposed change, including an assessment of its possible effects (including changes in emissions and waste production) on risks to the environment from the Permitted installation;
  - b) Any relevant supporting information (e.g. chemical/fuel consumption, technical details, changes in the type/use of substances/mixtures, etc.);
  - c) Any relevant supporting assessments and drawings; and

d) The proposed - date.

Any such change shall only be implemented following the issue of a modification of the permit by the Authority.

4.5.2 The Permit Holder shall notify the Authority, without undue delay, of any planned change.

#### **4.6 Ozone Depleting Substances**

4.6.1 No new equipment or components (including refrigeration and firefighting equipment or insulation foam) containing substances falling within the scope of EC Regulation No. 1005/2009 on substances that deplete the Ozone Layer & S.L. 549.58, Substances depleting the ozone layer regulations shall be installed within the site.

#### **4.7 Closure and Decommissioning**

4.7.1 The Permit Holder shall notify the Authority prior to ceasing operations permanently in part or full, whereby an application for cessation of operations shall be made to the Authority and shall include a decommissioning plan.

4.7.2 In the event of cessation of operations on the site, the Permit Holder shall remain responsible for all wastes and hazardous materials on site, which shall be removed from the site in accordance to good environmental practice and in such a manner that minimises environmental risks.

4.7.3 The Decommissioning Plan shall be implemented once approved by the Authority and within 12 months of final cessation of operations or as agreed with the Authority in writing.

4.7.4 All obligations of this permit shall subsist until such time that the Authority notifies the Permit Holder in writing that all obligations and conditions of the permit have been fulfilled without prejudice to any liabilities and third-party rights.

4.7.5 When deemed necessary, the Authority may require the Permit Holder to take such additional measures as it considers necessary with respect to after care obligations in relation, but not limited to the remedial action, rehabilitation, and monitoring of the waste management or waste production site.

4.7.6 In the event of cessation of operations of any plant and equipment specified in this permit and/or which is integral to the carrying out of the permitted operations, the Permit Holder shall notify the Authority about the type of equipment, its intended fate and details of the transferee.

Unless the plant/equipment shall be transferred off-site in its current state, the Permit Holder shall submit a plan to the Compliance and Enforcement Unit which shall include the following details:

- a. The appointed contractor or other competent person who shall carry out any works (e.g. cleaning, dismantling etc.).
- b. A complete inventory of all the materials that shall be dismantled/removed, including waste streams classified according to their respective EWC code as per S.L. 549.63 and details on the manner in which waste will be managed. Waste resulting from depollution shall also be included.
- c. The proposed cleaning, dismantling and transport procedures.
- d. Precautions and mitigation measures during such works to prevent spillages and other potential emissions to the environment.
- e. Timeframes associated with the implementation of this plan.

For any plant/equipment and/or parts thereof, which shall not be considered as waste in accordance with S.L. 549.63, The Waste Regulations, a certificate of good working order from an independent warranted engineer shall be submitted to the Compliance and Enforcement Unit following any works that may be necessary at the permitted installation.

## **5 General Conditions**

- 5.1 This permit is granted saving third party rights and without prejudice to any other legislation or regulations or authorisations required from any other competent authorities or site owners.
- 5.2 In these conditions and their interpretation, all terms shall have the same meaning as that assigned to them CAP549 Environment Protection Act and its subsidiary legislation.
- 5.3 The Permit Holder has the sole responsibility to ascertain compliance with legal obligations, permit conditions and to undertake operations on and off site in line with good environmental practices at all times.
- 5.4 The Permit Holder shall maintain a register of third party complaints. The register shall record the details of complainant(s) if available, the date, source and nature of the complaint and the corrective action undertaken, where such action proves necessary.
- 5.5 The Permitted Installation shall be managed, controlled, supervised and operated by staff that are aware of the importance of environmental protection and suitably trained on the requirements of this Permit, in particular on those permit conditions relevant to their duties. All staff shall be provided with adequate training and written operating instructions to enable them to effectively carry out their duties. Such training shall be recorded and maintained. Subcontractors engaged in operations concerning the operations authorised by this permit shall also be made aware of any obligations arising from the permit which might affect their duties.
- 5.6 Upon the joint application of a Permit Holder and a proposed transferee, the Permit Holder may request to transfer the Environmental Permit. The permit shall not be

transferred from the Permit Holder without prior approval from the Authority. Upon the Authority's decision to transfer the permit to the transferee, all rights, obligations, liabilities shall subsist onto the transferee.

- 5.7 The Authority may carry out regular pre-set or unannounced compliance or monitoring checks that vary in frequency according to the site's compliance with the permit conditions and safeguarding of natural assets. Any checks or audits carried out by the Authority may be made at the Permit Holder's financial expense at the rate and arrangement communicated by ERA.
- 5.8 The Authority's representatives may inspect and photograph any part of the site and ask for any closed or locked areas to be opened and may demand to be provided with any proof, documentation, plans, receipts or any other records.
- 5.9 The Authority may add, amend, delete or substitute any of the conditions of this permit after notifying the Permit Holder of its intention and after describing the changes to the Permit Holder. This is without prejudice to any prevailing circumstances that would preclude the Authority from following such a procedure.
- 5.10 The permit is valid for a period of **four (4) years** from the date of the granting. The Permit Holder may apply for a renewal of this permit expressing their intention at least eleven **(11) months** prior to the expiry of this permit. The permit will be considered renewed once the official renewed permit is granted by the Authority.
- 5.11 In accordance to the provisions of Subsidiary Legislation 549.63, this permit is granted against a bank guarantee of **€12,000 + €6,000** which shall be renewed annually. This guarantee will have to be maintained throughout the validity of the permit. Following renewal and/or variations to this permit, the Authority may require amendments to the Bank Guarantee.
- 5.12 A sum of €2,000 shall be released from the financial guarantee by the Authority upon the permit holder's request and following verification that the respective phase has been completed to the Authority's satisfaction, as specified in Condition 1.2.3 and in **EP 00224/25/DOC54A**, up to a maximum total of €6,000.
- Failure to fulfil the requirements of Condition 1.2.3 within the permit validity period shall result in forfeiture from the Bank Guarantee, up to a maximum of €6,000, at a rate of €2,000 per incomplete phase.
- 5.13 The Authority may withdraw funds from the bank guarantee for any breach of permit conditions, instructions, or legal obligations under the Act or its subsidiary legislation. This does not preclude further enforcement action by ERA. If funds are withdrawn, the Permit Holder shall replenish the guarantee within two (2) months. Release of the Bank Guarantee is subject to the Authority's confirmation of full compliance.
- 5.14 In cases where the bank guarantee does not cover the expenses incurred by the Authority to take any remedial action on the Permit Holder's behalf, the Permit Holder is to financially reimburse the Authority of all the expenses incurred.
- 5.15 A copy of this permit shall be available at all times at the site office, including any Variation/Modification Notices to it.

- 5.16 The Authority may suspend or revoke all or part of this environmental permit in line with the provisions of CAP549.
- 5.17 The Authority may request monitoring, installation of abatement equipment and/or review of operational practices and may commission any audits/reports as deemed necessary to address any circumstances that may affect the quality of the surrounding environment, at the expense of the Permit Holder.
- 5.18 Without prejudice to condition 5.19, the Authority may take any action deemed necessary including but not limited to the suspension of any operation until investigations are concluded.
- 5.19 The Authority may stop any consignment/s of waste in transit from the site should the Authority require any checks and/or investigations on such a consignment/s.
- 5.20 Treated/dismantled waste, resultant waste components and fractions being stored as outgoing waste shall be stored separately from the incoming waste. All separated outgoing waste shall be kept separate and shall not be mixed.
- 5.21 All persons have a duty of care to protect the environment. The Permit Holder shall become familiar with their legal obligations and good environmental practice.

**Schedule 1****Complete List of Permitted Waste on Site****INCOMING WASTE:**

02 01 10	Waste metal
11 05 01	Hard zinc
11 05 02	Zinc ash
12 01 01	Ferrous metal filings and turnings
12 01 03	Non-ferrous metal filings and turnings
15 01 04	Metallic Packaging
16 01 04*	End-of-life vehicles
16 01 06	End-of-life vehicles containing neither liquids nor other hazardous components
17 04 01	Copper, bronze, brass
17 04 02	Aluminium
17 04 03	Lead
17 04 04	Zinc
17 04 05	Iron and Steel waste
17 04 06	Tin
17 04 07	Mixed metals
19 10 01	Iron and Steel waste
19 10 02	Non-ferrous waste
19 12 02	Ferrous metal
19 12 03	Non-ferrous metal
20 01 40	Metals

**OUTGOING WASTE**

13 01 10*	Mineral based non-chlorinated hydraulic oils
13 01 11*	Synthetic hydraulic oils
13 02 04*	Mineral-based chlorinated engine, gear and lubricating oils
13 02 05*	Mineral-based and non-chlorinated engine, gear and lubricating oils
13 02 06*	Synthetic engine, gear and lubricating oils
13 02 08*	Other engine, gear and lubricating oils
13 03 07*	Mineral-based non-chlorinated insulating and heat transmission oils
13 05 07*	Oily water from oil/water separators
13 07 01*	Fuel oil and diesel
13 07 02*	Petrol
13 07 03*	Other fuels (including mixtures)

- 14 06 01\* Chlorofluorocarbons, HCFC, HFC
  
- 16 01 03 End-of life tyres
- 16 01 06 End-of life vehicles, containing neither liquids nor other hazardous components
- 16 01 07\* Oil filters
- 16 01 08\* Components containing mercury
- 16 01 09\* Components containing PCBs
- 16 01 10\* Explosive components (e.g. air bags)
- 16 01 11\* Brake pads containing asbestos
- 16 01 12 Brake pads other than those mentioned in 16 01 11
- 16 01 13\* Brake fluids
- 16 01 14\* Antifreeze fluids containing hazardous substances
- 16 01 15 Antifreeze fluids other than those mentioned in 16 01 14
- 16 01 16 Tanks for liquefied gas
- 16 01 17 Ferrous metal
- 16 01 18 Non-ferrous metal
- 16 01 19 Plastic
- 16 01 20 Glass
- 16 01 22 Components not otherwise specified
- 16 01 99 Upholstery
  
- 16 02 11\* Discarded equipment containing chlorofluorocarbons, HCFC, HFC
- 16 02 15\* Hazardous component from WEEE
- 16 02 16 Components from WEEE
  
- 16 06 01\* Lead batteries
- 16 06 05 Other batteries and accumulators
  
- 16 08 01 Spent catalysts containing gold, silver, rhenium, rhodium, palladium, iridium or platinum (except 16 08 07)
- 16 08 02\* Spent catalysts containing hazardous transition metals or hazardous transition metal compounds
- 16 08 03 Spent catalysts containing transition metals or transition metal compounds not otherwise specified
  
- 16 10 01\* Aqueous liquid wastes containing hazardous substances
  
- 19 10 01 Iron and steel waste
- 19 10 02 Non-ferrous waste
  
- 19 12 02 Ferrous metal
- 19 12 03 Non-ferrous metal

**N.B. Incoming wastes may also leave the site as Outgoing Waste, except where it is otherwise explicitly specified.**

Schedule 2A  
Site Map

---



**Fig. 2.1: Site of permitted installation, showing the permitted area outlined in black, for the carrying out of the operations specified in Condition 1.1.1. The extent of the site boundary is indicative and shall not be used for interpretation purposes.**

Schedule 2B  
Site Layout Plan

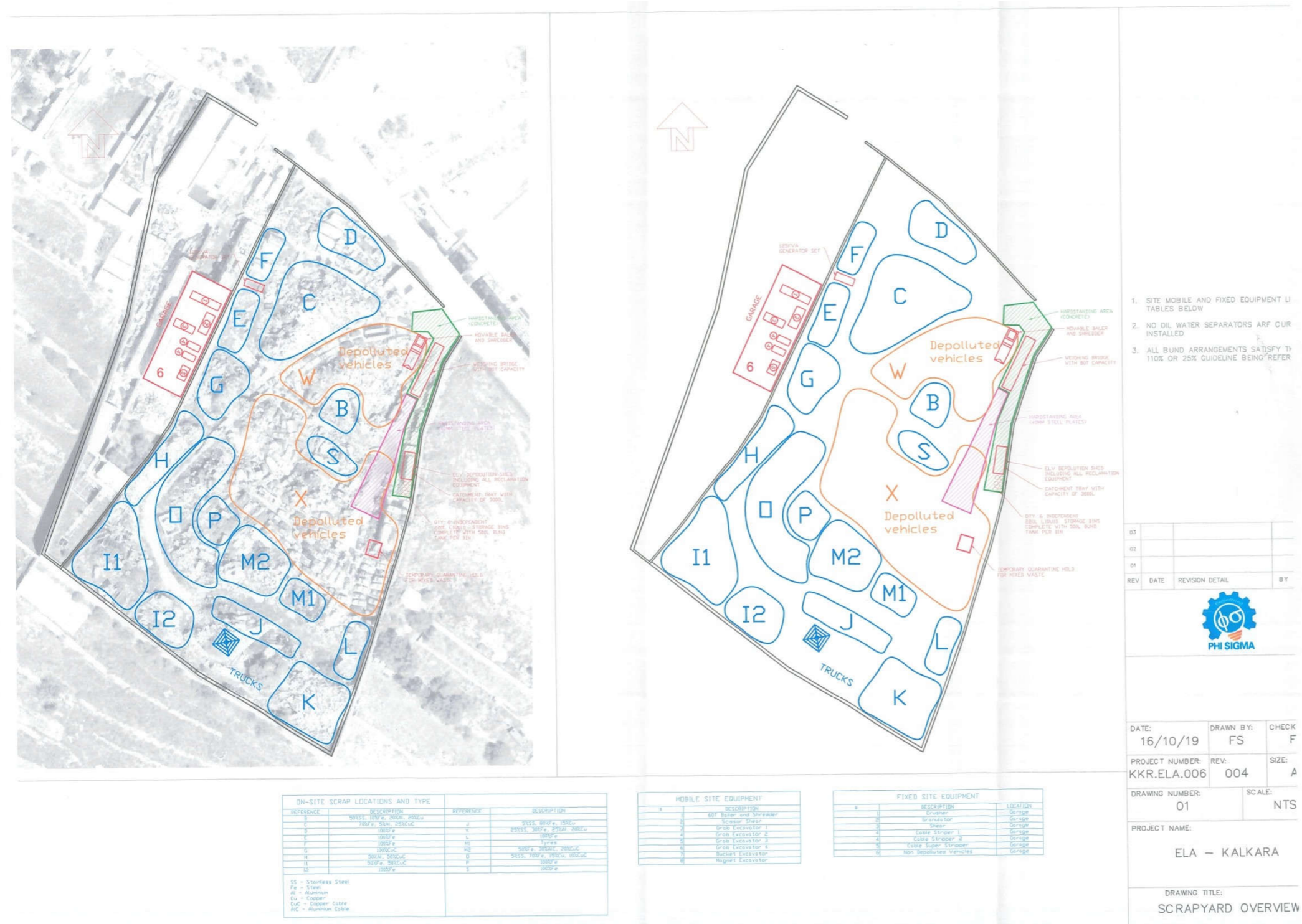

Fig. 2.2: Site layout plan of permitted installation at present for the carrying out of the operations specified in Condition 1.1.1. The extent of the site boundary is indicative and shall not be used for interpretation purposes.

Schedule 2C  
Site Layout Plan

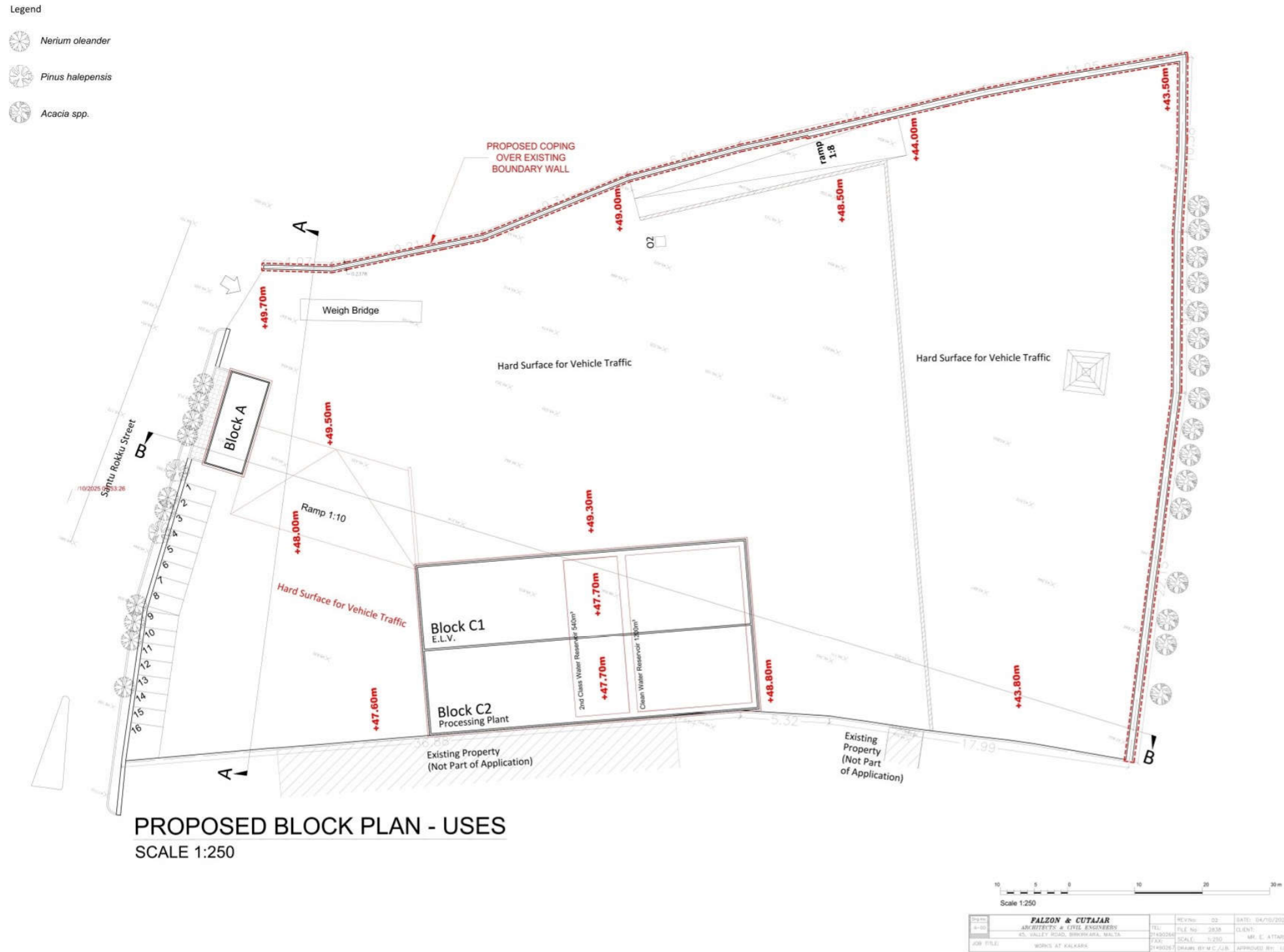

Fig. 2.3: Site layout plan of permitted installation following infrastructural works for the carrying out of the operations specified in Condition 1.1.1. The extent of the site boundary is indicative and shall not be used for interpretation purposes

### Schedule 3

#### Annual Environment Report and Submissions

**Important note**

By this submission, you confirm that you give your explicit consent for the entire contents of this Annual Environment Report to be made available on the Authority's public website.

### S3.1 Introduction

Environmental Permit Number	
Reporting Year (Calendar Year: 1 January to 31 December)	
Name and locality of Site	
Brief description of operations at the site	

### S3.2 Waste Records

As per condition 4.4.1, the Permit Holder shall submit to the Authority information on waste records of the previous year by not later than end of March of each year, providing the information listed in the ERA website and in the format specified therein (<https://era.org.mt/era-topic-categories/reporting-obligations/>).

### S3.3 Incidents and Complaints

#### S3.3.1 Non-Compliance Incidents during Reporting Year

Date of incident	Brief description of Incident	Cause	Corrective action

Total number of non-compliance incidents for the previous reporting period: <sup>1</sup>	
Total number of non-compliance incidents for the current reporting period:	

#### S3.3.2 Complaints made by the public or through Authority

Date of complaint	Description of complaint	Actions taken

Total number of complaints for previous reporting year: <sup>i</sup>	
Total number of complaints for current reporting period:	

<sup>1</sup> "Previous year" data is not required in the first reporting year (2020).

**S3.4 Submission of certificates**

Certification for the generator (PS1) of good working order as per condition 2.1.7	<input type="checkbox"/>
Certification of all cesspits within the installation once in place and with the application for renewal as per condition 2.2.5	<input type="checkbox"/>
Certification of oil interceptor every year once installed as per condition 2.2.7	<input type="checkbox"/>
Certification for site containment and drainage systems as per condition 3.1.6 shall be submitted to ERA upon completion of works and upon renewal	<input type="checkbox"/>
Certification for bunds with the next renewal application as per condition 3.1.9	<input type="checkbox"/>
Certification of integrity for secondary containment upon application for renewal as per condition 3.1.10	<input type="checkbox"/>
Certification of weighing equipment every year as per condition 3.3.1	<input type="checkbox"/>
Submission of Annual Environment Report and Waste Records every year as per condition 4.4.1	<input type="checkbox"/>
Recycling Efficiency Certificates or certification/declaration as necessary as per condition 4.4.2	<input type="checkbox"/>
Submission of Waste Audit as per condition 4.4.3	<input type="checkbox"/>

<b>Permit Holder's declaration</b>		
<i>I declare that, to the best of my knowledge, all the above information is correct and substantiated.</i>		
..... <b>Name</b> <i>(in block letters)</i>	..... <b>ID Card Number</b>	..... <b>on behalf of / in my own name</b> <i>(in block letters)</i>
..... <b>Signature</b>	..... <b>Date</b>	

#### **Schedule 4**

---

#### **Minimum requirements for ELV certificate of Destruction**

1. Name, address, signature and registration or identification number of the Permit Holder issuing the certificate;
2. Name and address of the Competent Authority responsible for the permit (in accordance with Regulation 6 of S.L. 549.36) for the establishment or undertaking issuing the certificate of destruction;
3. Date of issue of the certificate of destruction;
4. Vehicle nationality, mark and registration number (attach the registration document or a statement by the establishment issuing the certificate that the registration document has been destroyed);
5. Class of vehicle, brand and model;
6. Vehicle identification (chassis) number;
7. Name, address, nationality and signature of the holder or owner of the vehicle delivered.

Where the certificate is issued by a producer, dealer or collector on behalf of an authorized treatment facility, the name and address and registration or identification number of the establishment/undertaking issuing the certificate is also required on the Certificate of Destruction.

## Schedule 5

---

### Minimum requirements for an Environment Management System (EMS)

---

An EMS shall as a minimum, the following elements:

#### 1. Management and Reporting Structure

This shall in particular include the name of the person who will be responsible for managing environmental aspects of the installation. Relevant qualifications and experience shall be listed, together with contact details (including a mobile number for emergency purposes).

#### 2. Environmental Objectives and Targets

The section shall include a review of all operations and processes, a commitment by the Permit Holder to continuous improvement, and identification of priority areas where improvement to the operations is necessary and practicable, such as:

- a. recycling of materials;
- b. minimisation of waste;
- c. efficient use of resources (especially water and energy);
- d. use of biodegradable chemicals;
- e. minimising use of solvents;
- f. procedures to minimise noise disturbance to neighbours;

Targets shall be set for priority areas identified (e.g. minimising waste generation by \_\_\_% annually).

#### 3. Environmental Management Programme (EMP)

This shall include a time schedule for achieving the Environmental Objectives and Targets prepared under point 2 above. The time schedule shall cover a period of 5 years. The EMP shall include:

- a. designation of responsibility for targets;
- b. the means by which they may be achieved;
- c. the time within which they may be achieved.

Targets and performance shall be reviewed annually as part of the EMS.

#### 4. Documentation

A system of documentation shall be established to ensure that records are kept of the priority areas chosen according to point 2. In addition, the Permit Holder shall issue a copy of the environmental permit to all relevant personnel whose duties relate to any condition of the permit.

#### 5. Corrective Action

The Permit Holder shall establish procedures to ensure that corrective action is taken shall the specified requirements of the environmental permit not be fulfilled. The responsibility and authority for initiating further investigation and corrective action in the event of a nonconformity with the environmental permit shall be defined.

#### 6. Awareness and Training

The Permit Holder shall establish and maintain procedures for identifying training needs, and for providing appropriate training, for all personnel whose work can have an effect on the environment. Appropriate records of training shall be maintained.

#### 7. Maintenance Programme

The Permit Holder shall establish and maintain a programme for maintenance of all plant and equipment based on the instructions issued by the manufacturer/supplier or installer of the equipment. Appropriate record keeping and diagnostic testing shall support this maintenance programme.

The licensee should clearly allocate responsibility for the planning, management and execution of all aspects of this programme to appropriate personnel.

## Schedule 6

### **Terms of Reference for Compliance Audits related to Annual Reporting for Authorised Waste Facilities**

- S6.1 The auditor shall be independent (i.e. an auditor who would be eligible for appointment as company auditor), certified, and approved by the Authority. The auditor should have access to in-house environmental expertise or otherwise appoint a consultant having environmental expertise to assist him.
- S6.2 The auditor would be required to certify all the information reported to the Authority by the Authorised Waste Facility as specified in the ERA permit itself.
- S6.3 A sound auditing procedure for traceability, monitoring, and control should be in place for all the authorised waste managed on site in relation to the Waste Management permit or an Environmental permit.
- S6.4 The audit trail should cover all waste from the point of acceptance of waste into the facility to the end recovery or disposal facility (local or foreign).
- S6.5 Proper records and documentation should be kept where authorised waste are sent to duly authorised interim storage facilities, pending transfer to an authorised end disposal/recovery facilities. In such cases, proof is to be provided, as regards to that the authorised waste has been transferred to an authorised end disposal/recovery facility within a maximum of twelve (12) calendar months from the end of the annual reporting period.

The points overleaf shall be covered by the auditors in such audits, providing a detailed report of their findings. The Authority may reserve the right to request clarifications and further information from the auditors other than that provided in the audit report.

#	Nature and extent of audit procedures	Timing	Done by and date	W/P ref
1	<p><b>Objective: To confirm that there is a signed receipt for every waste transfer received at the site</b></p> <ul style="list-style-type: none"> <li>Choose a random sample of 10% of the signed receipts for every waste transfer received at the site for each quarter within the calendar year and confirm that all waste entries are covered by an issued signed receipt.</li> </ul>			
2	<p><b>Objective: To ensure that an adequate audit trail is maintained to ensure that when a particular waste stream is being treated it can be traced back to its waste generator</b></p> <ul style="list-style-type: none"> <li>Choose a random sample of 10% of the total waste being treated and ensure that its origin can be traced back.</li> </ul>			
3	<p><b>Objective: To confirm that any hazardous waste movements from the site (entry &amp; exit) are covered with a hazardous waste consignment permit and consignment note</b></p> <ul style="list-style-type: none"> <li>In cases of movement within the island of Malta, choose a random sample of 10% of the total no. of hazardous waste movements into and out of the site and confirm that all such movements are covered by a valid hazardous waste consignment permit and a waste consignment note. Confirm also that the relevant EWC code has been used.</li> </ul>			
4	<p><b>Objective: To confirm that any hazardous waste movements from the site (entry &amp; exit) are covered with relevant TFS documentation of the Waste Shipments Regulation in cases of export</b></p> <ul style="list-style-type: none"> <li>In cases of export, choose a random sample of 10% of the total no. of hazardous waste movements out of the site and the relevant TFS movement forms and confirm that all such movements are covered by valid relevant documentation. Confirm also that the relevant EWC code has been used.</li> <li>In the case of waste broker usage, ensure that the waste brokers used are registered with ERA as such.</li> </ul>			

5	<p><b>Objective: To confirm that any movement of non-hazardous waste movements from the site being sent for treatment abroad are covered by the relevant Annex VII documentation of the Waste Shipments Regulation in cases of export</b></p> <ul style="list-style-type: none"> <li>Choose a random sample of 10% of the total no. of non-hazardous waste movements into and out of the site are covered by valid relevant documentation and/or records. Confirm also that the relevant EWC code has been used.</li> <li>In the case of waste broker usage, ensure that the waste brokers used are registered with ERA as such.</li> </ul>			
6	<p><b>Objective: To verify whether the quantities reported by the Waste Facility make reasonable sense</b></p> <ul style="list-style-type: none"> <li>Choose a random sample of 10% of the total amount of waste being handled at the facility and confirm that all waste entries (in and out of the site) reported are verified by relative documentation and/or records.</li> </ul>			
7	<p><b>Objective: To ensure that the waste vehicles used by the authorised facility to transfer the waste to other permitted sites are registered with ERA</b></p> <ul style="list-style-type: none"> <li>Obtain a list of approved waste carriers from ERA and confirm that the ones used by facility are registered with ERA.</li> </ul>			
8	<p><b>Objective: To ensure that, in cases where waste is transferred from the facility to other waste management facilities, locally or abroad, the waste management facilities used would either be approved by ERA or the Competent Authority of the Country of Destination</b></p> <ul style="list-style-type: none"> <li>Obtain a list of locally approved waste management facilities from ERA and confirm that the ones used by the facility are approved and authorised by ERA. Obtain a copy of the permits of any foreign authorised waste management facilities which have been utilised. An original copy of the permit and an approved translated version of the permit is to be presented to ERA.</li> </ul>			

<p><b>9</b></p>	<p><b>Objective: To ensure that the declared quantities of waste exported during the previous calendar year were actually received at the authorised facilities and declared to ERA</b></p> <ul style="list-style-type: none"> <li>• Obtain all certificates received from recycling facilities and confirm that these have all been declared to ERA prior to shipment</li> <li>• Confirm arithmetical correctness of all reported data in this regard.</li> </ul>			
<p><b>10</b></p>	<p><b>Objective: To identify the waste being treated both locally and abroad, and ensure that it has been recovered appropriately</b></p> <ul style="list-style-type: none"> <li>• Ensure that all relevant documentation, including but not limited to, the hazardous waste consignment permit and consignment note applications, are available in case of local treatment.</li> <li>• Identify the materials exported according to the EWC Code and review actual documentation (including bills of lading) confirming an audit trail showing that the waste has been sent to a recovery facility as per permit requirements.</li> </ul>			

**Schedule 7**

**Packaging disposal/recovery certificates (ERA form)**

**Example 1 (separately collected packaging waste):**

### Recovery/Disposal Certificate for Packaging Waste

Certificate Number: **WPC 00123**

Date of Issuance: \_\_\_\_\_

I, Name of Establishment/Undertaking, with authorisation number EP 000X/YY/Z certify that quantity tonnes of category of (paper) packaging waste classified under EWC code 15 01 01 has been collected from name of waste generator on/in DD/MM/YYYY. The waste collected has been treated as indicated in the following table:

**END OF PERMIT**

% Recovered / Disposed	Amount (in kg)	Recovery/ Disposal Code	Category of mixed Packaging waste under 15 01 06	Fate of Waste	Proof of Recovery / Disposal
60	120,000	R3	N/A	Exported directly to <i>Country of Destination</i>	Container No <b>CMAU1234567</b>
20	40,000	R3	N/A	Recovered/Disposed Locally at <i>Name of Establishment/Undertaking</i>	Certificate Number <b>WPC 00124</b>
10	20,000	R3	N/A	Sold to <i>Name of Establishment/Undertaking</i>	Certificate Number <b>WPC 00125</b>
10	20,000	D1	N/A	Disposed Locally at <i>Name of Establishment/ Undertaking</i>	Certificate Number <b>WPC 00126</b>

\_\_\_\_\_  
Name, Signature and Stamp



**Environment & Resources Authority**  
Hexagon House, Spencer Hill, Marsa MRS 1441  
T: (+356) 2292 3500 E: info@era.org.mt W: era.org.mt



**\*Disclaimer:** This certificate has been issued on the official ERA form and shall not be construed as a certificate issued by ERA.

**Example 2 (mixed packaging waste):**

## Recovery/Disposal Certificate for Packaging Waste

Certificate Number: **WPC 00123**

Date of Issuance: \_\_\_\_\_

I, Name of Establishment/Undertaking, with authorisation number EP 000X/YY/Z certify that quantity tonnes of mixed packaging waste classified under EWC code 15 01 06 has been collected from name of waste generator on/in DD/MM/YYYY. The waste collected has been treated as indicated in the following table:

% Recovered / Disposed	Amount (in kg)	Recovery/ Disposal Code	Category of mixed Packaging waste under 15 01 06	Fate of Waste	Proof of Recovery / Disposal
25	50,000	R3	Plastic packaging	Exported directly to <i>Country of Destination</i>	Container No <i>CMAU1234567</i>
50	100,000	R3	Cardboard	Recovered/Disposed Locally at <i>Name of Establishment/Undertaking</i>	Certificate Number <i>WPC 00124</i>
15	30,000	R3	Metallic packaging	Sold to <i>Name of Establishment/Undertaking</i>	Certificate Number <i>WPC 00125</i>
N/A	N/A	N/A	N/A	N/A	N/A

\_\_\_\_\_  
Name, Signature and Stamp



**Environment & Resources Authority**  
Hexagon House, Spencer Hill, Marsa MRS 1441  
T (+356) 2292 3500 E info@era.org.mt W era.org.mt



**\*Disclaimer:** This certificate has been issued on the official ERA form and shall not be construed as a certificate issued by ERA.